

MEMOREX MKA354 Mirrored Disco Ball with Spotlight

Pertaining to a Risk of Fire, Electric Shock, or Injury to Persons

IMPORTANT SAFETY INSTRUCTIONS

Read all instructions before using the MKA354 Mirrored Disco Ball with Spotlight.

DANGER – To reduce the risk of electric shock: Always unplug this furnishing from the electrical outlet before cleaning and the replacement of lamp bulb.

WARNING – To reduce the risk of burns, fire, electric shock, or injury to persons:

1. Unplug from outlet before putting on or taking off parts.
2. Close supervision is necessary when this furnishing is used by, or near children, invalids, or disabled persons.
3. Use this furnishing only for its intended use as described in these instructions. Do not use attachments not recommended by the manufacturer.
4. Never operate this furnishing if it has a damaged cord or plug, if it is not working properly, if it has been dropped or damaged, or dropped into water. Return the furnishing to a service center for examination and repair.
5. Keep the cord away from heated surfaces.
6. Never operate the furnishing with the air openings blocked. Keep the air openings free of lint, hair, and the like.
7. Never drop or insert any object into any opening.
8. For household use, do not use outdoors.
9. Do not operate where aerosol (spray) products are being used or where oxygen is being administered.
10. To disconnect, turn all controls and switch to the off position, then remove plug from outlet.

SAVE THESE INSTRUCTIONS

MEMOREX MKA354 Mirrored Disco Ball with Spotlight

Please read all instructions carefully before use.

OPERATION:

The distance between the mirrored ball and the light source should be at least 20 inches. When mounting the DC controller to the ceiling, please make sure to mount it properly. Use an “S” shaped hook (not included) to attach the mirrored ball to the DC controller axis. The ball must be able to move freely during operation.

Mount the Spotlight if desired as shown below. Plug the Spotlight into an electrical outlet and project the light beam onto the oscillating Mirrored Disco Ball.

SAFETY NOTES:

This Spotlight has a polarized plug (one blade is wider than the other) as a feature to reduce the risk of electric shock. This plug will fit in a polarized outlet only one way. If the plug does not fit fully in the outlet, reverse the plug. If it still does not fit, contact a qualified electrician. Never use with an extension cord unless the plug can be fully inserted. Do not alter the plug.

The external flexible cord of this Spotlight cannot be replaced; if the cord is damaged, the Spotlight should be disposed of or a qualified electrician must be consulted to repair it. Avoid any undue strain or stress on the product’s conductors, connections and wires while in use.

The Spotlight bulb will get HOT quickly during use. Turn off the unit and let it cool for five minutes prior to touching the unit or replacing the bulb. Use only a 20 watt or smaller bulb. The Spotlight is not a toy. Do not look directly at the bulb when it is lit. Keep it out of reach of children and pets. Not for professional use. When not in use, store the whole product with cord in the original packing in a cool, dry location protected from sunlight.

WARNING:

To reduce the risk of the fire or electric shock, do not expose this appliance to rain or moisture. Keep the lamp away from materials that may burn.
FOR INDOOR USE ONLY.

SPECIFICATIONS:

Mirrored Disco Ball

POWER RATING: 1.5VDC, 1 x D size battery

Spotlight

INPUT : 120V~, 60Hz

OUTPUT : 12V~, 20W MAX.

BULB : PAR36, 12V, 20W

Note: The dowel and the screws are not included.

BULB REPLACEMENT/ASSEMBLY OF SPOTLIGHT:

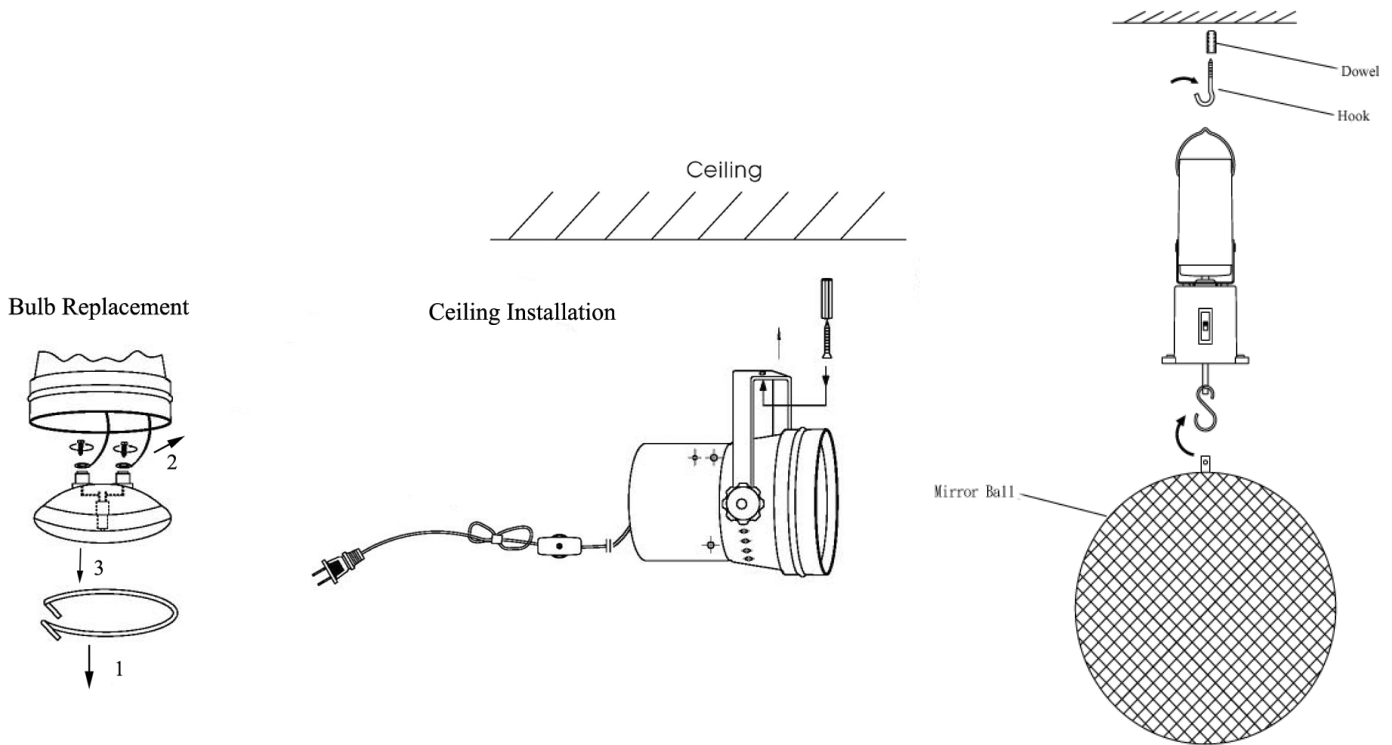

IF YOU HAVE ANY ADDITIONAL QUESTIONS REGARDING THIS PRODUCT, PLEASE CONTACT MEMOREX CONSUMER SERVICES AT 1-800-919-3647 OR VISIT OUR WEBSITE AT www.memorexelectronics.com .

FOR PARTS AND ACCESSORIES, PLEASE CONTACT FOX INTERNATIONAL AT 1-800-321-6993.

Please keep all packaging material for at least 90 days in case you need them to return this product to your place of purchase or to Memcorp.